

Embed a Panopto Video in D2L by Using the Insert Stuff Option

Step 1: Open D2L, navigate to the location where you intend to insert the video, then click on **New** to create a file.

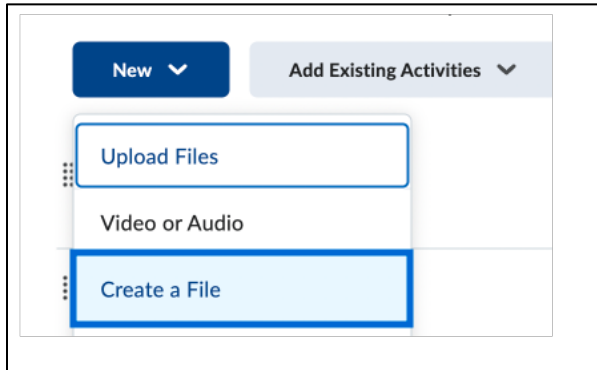

Step 2: Click on **Insert Stuff** to insert the Panopto video.

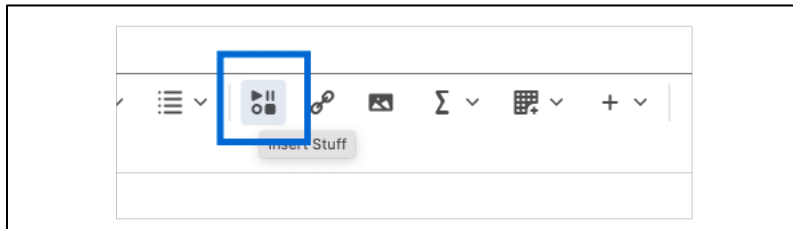

Step 3: Select **Panopto Embed**.

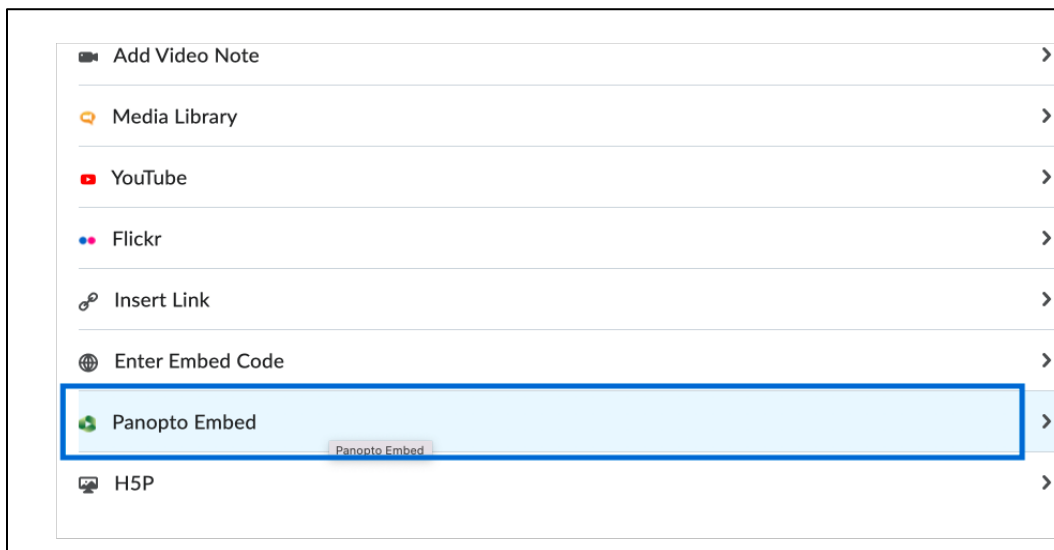

Embed a Panopto Video in D2L by Using the Insert Stuff Option

Step 4: Locate **My Folder** by clicking the drop-down menu near the top of the pop-up window.

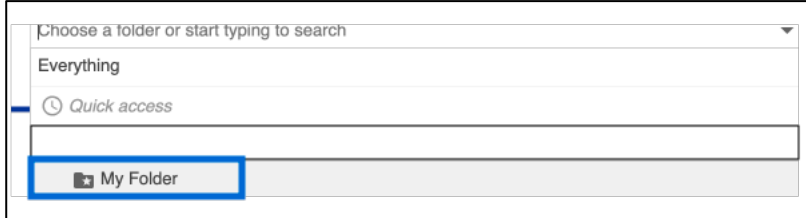

Step 5: Select the video to be embedded, clicking the radio button to the left of the video title and then clicking the **Insert** button.

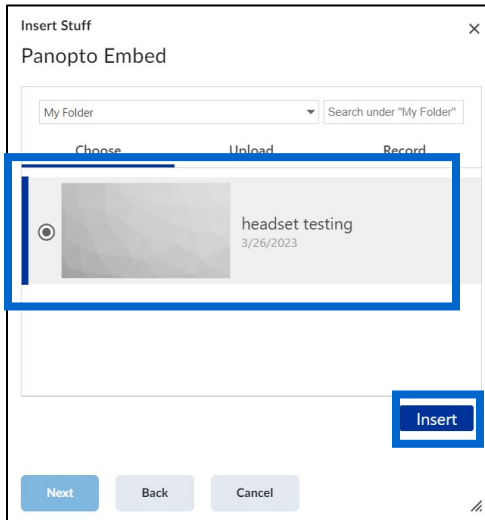

Step 6: Click the **Insert** button on the Preview screen that appears.

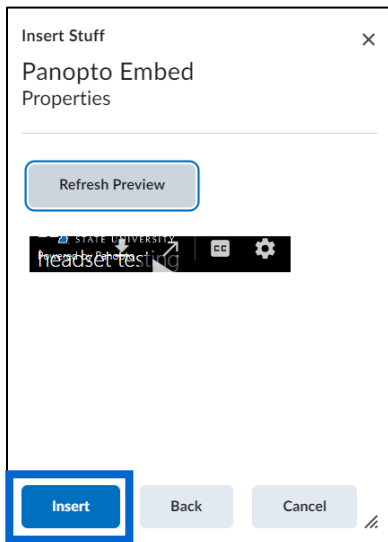

Embed a Panopto Video in D2L by Using the Insert Stuff Option

Step 7: Preview the video, enter a title, and click **Save and Close**.

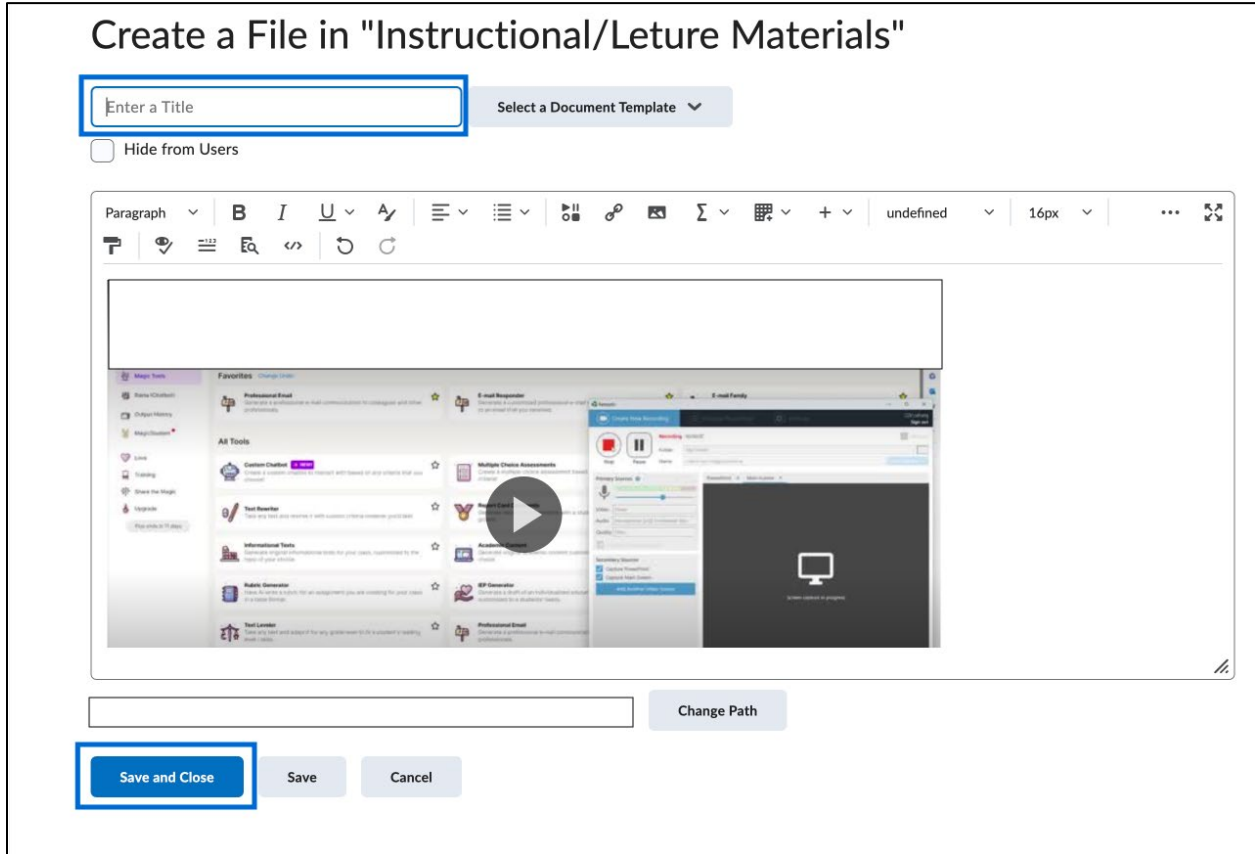

Create a File in "Instructional/Lecture Materials"

Enter a Title Select a Document Template

Hide from Users

Paragraph **B** *I* U ~~A~~ undefined 16px

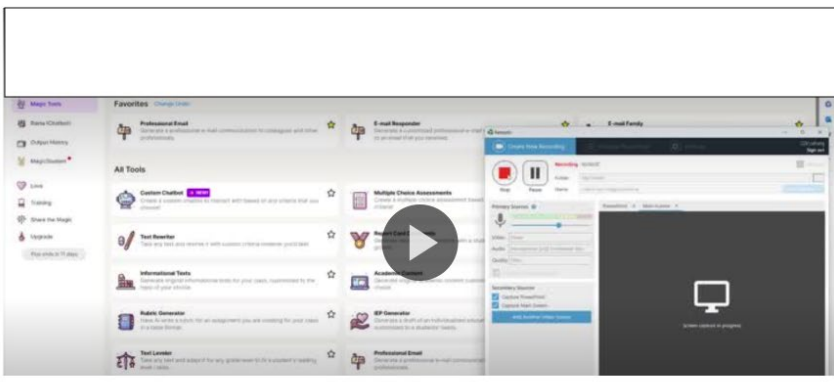

Change Path

Save and Close Save Cancel